

DIN 934 ähnlich ISO 4032

Sechskantmuttern

Außensechskant

Stahl 10 | blank | Cr(VI) - frei | Metrisches Gewinde

Hinweis: DIN-Norm wurde zurückgezogen | abweichende Schlüsselweiten bei M10, M12, M14 und M22 | Feingewinde wurde in ISO 8673 überführt

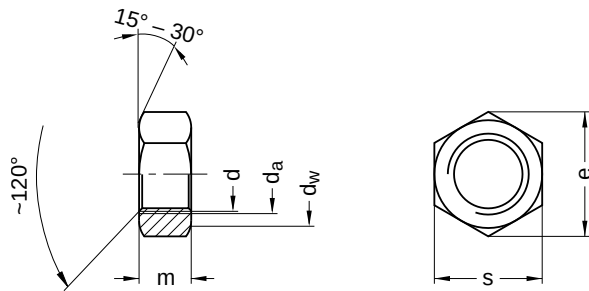

| Durchmesser (d) | d _a | | d _w | e | m | | s | | Steigung (P) |
|--------------------|----------------|-------|----------------|-------|-------|------|-------|------|-----------------|
| | min. | max. | | | min. | max. | min. | max. | |
| M 3 | 3 | 3,45 | 4,5 | 6,01 | 2,15 | 2,4 | 5,32 | 5,5 | 0,50 |
| M 4 | 4 | 4,60 | 5,8 | 7,66 | 2,90 | 3,2 | 6,78 | 7,0 | 0,70 |
| M 5 | 5 | 5,75 | 6,8 | 8,79 | 3,70 | 4,0 | 7,78 | 8,0 | 0,80 |
| M 6 | 6 | 6,75 | 8,8 | 11,05 | 4,70 | 5,0 | 9,78 | 10,0 | 1,00 |
| M 8 | 8 | 8,75 | 11,3 | 14,38 | 6,14 | 6,5 | 12,73 | 13,0 | 1,25 |
| M 10 | 10 | 10,80 | 15,3 | 18,90 | 7,64 | 8,0 | 16,73 | 17,0 | 1,50 |
| M 12 | 12 | 13,00 | 17,2 | 21,10 | 9,64 | 10,0 | 18,67 | 19,0 | 1,75 |
| M 14 | 14 | 15,10 | 20,2 | 24,49 | 10,30 | 11,0 | 21,67 | 22,0 | 2,00 |
| M 16 | 16 | 17,30 | 22,2 | 26,75 | 12,30 | 13,0 | 23,67 | 24,0 | 2,00 |
| M 18 | 18 | 19,50 | 25,3 | 29,56 | 14,30 | 15,0 | 26,16 | 27,0 | 2,50 |
| M 20 | 20 | 21,60 | 28,2 | 32,95 | 14,90 | 16,0 | 29,16 | 30,0 | 2,50 |
| M 22 | 22 | 23,70 | 29,5 | 35,03 | 16,90 | 18,0 | 31,00 | 32,0 | 2,50 |
| M 24 | 24 | 25,90 | 33,2 | 39,55 | 17,70 | 19,0 | 35,00 | 36,0 | 3,00 |
| M 27 | 27 | 29,10 | 38,0 | 45,20 | 20,70 | 22,0 | 40,00 | 41,0 | 3,00 |
| M 30 | 30 | 32,40 | 42,7 | 50,65 | 22,70 | 24,0 | 45,00 | 46,0 | 3,50 |
| M 33 | 33 | 35,60 | 46,6 | 55,37 | 24,70 | 26,0 | 49,00 | 50,0 | 3,50 |
| M 36 | 36 | 38,90 | 51,1 | 60,79 | 27,40 | 29,0 | 53,80 | 55,0 | 4,00 |
| M 39 | 39 | 42,10 | 55,9 | 66,44 | 29,40 | 31,0 | 58,80 | 60,0 | 4,00 |
| M 42 | 42 | 45,40 | 60,6 | 71,30 | 32,40 | 34,0 | 63,10 | 65,0 | 4,50 |
| M 45 | 45 | 48,60 | 64,7 | 76,95 | 34,40 | 36,0 | 68,10 | 70,0 | 4,50 |
| M 48 | 48 | 51,80 | 69,4 | 82,60 | 36,40 | 38,0 | 73,10 | 75,0 | 5,00 |
| M 52 | 52 | 56,20 | 74,2 | 88,25 | 40,40 | 42,0 | 78,10 | 80,0 | 5,00 |

Alle technischen Daten beziehen sich auf das Maß mm

