

DIN
TYPE

HOSE NIPPLES

— MALE THREAD TYPE / EXTENSION TYPE —

Use in atmospheric pressure 2,500 Kpa (25.49 kgf/cm²) or lower.

Male thread type (Water use)



Type	Valve	max. °C	Thread
D-NPW	—	100	MxP
D-NPWG	—	100	PF(G)

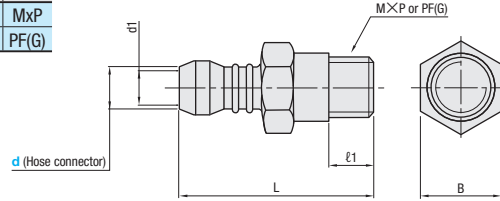

C3604

Metric thread type

B	L	ℓ1	d1	M×P	Part No.		M
					Type	d	
11	40.5	7	6	M10×1.0	D-NPW	9	10
						13	12
15	47	9	8	M12×1.5		14	13
			9	M14×1.5		19	24
27	62	12	13	M24×1.5			

Parallel pipe thread type

B	L	ℓ1	d1	PF(G)	Part No.		No.
					Type	d	
11	40.5	7	6	G1/8A	D-NPWG	9	1
15	47	9	9	G1/4A		13	2
27	62	12	13	G1/2A		19	4



Order

Part No.	—	M
D-NPW13	—	14
Part No.	—	No.
D-NPWG13	—	2



Days to Ship



Stock



Price

Order / Quote:

WOS: <https://in.misumi-ec.com/>

TEL:+91-124-468-8800 E-mail:cs@misumi.co.in

Male thread type (Air use)



D-NPAG

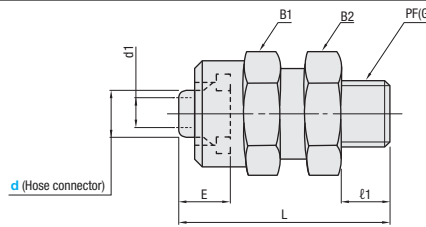

C3604

Usable temperature up to 100 °C

B1	B2	L	ℓ1	E	d1	PF(G)	Part No.		No.
							Type	d	
14	14	25	7	7	5	G1/8A	D-NPAG	6	1



Order

Part No.	—	No.
D-NPAG6	—	1



Days to Ship

Stock



Price

Order / Quote:

WOS: <https://in.misumi-ec.com/>

TEL:+91-124-468-8800 E-mail:cs@misumi.co.in

Extension type



D-W

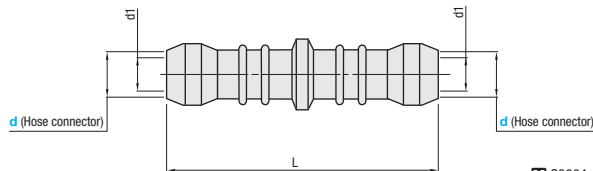

C3604

Usable temperature up to 100 °C

L	d1	Part No.	
		Type	d
48	6	D-VV	9
54	9		13
69	13		19



Order

Part No.	—
D-VV9	—



Days to Ship

Stock



Price

Order / Quote:

WOS: <https://in.misumi-ec.com/>

TEL:+91-124-468-8800 E-mail:cs@misumi.co.in

